

BACKING RING

With steel insert acc.to
ANSI standard PP grey
法兰铁片150#

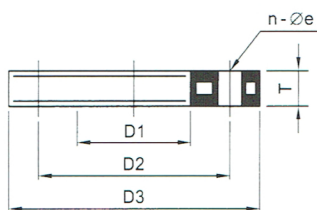

OD (inch)	D1 (mm)	D2		D3 (mm)	e (mm)	n Number	T (mm)
		(mm)	(inch)				
1/2"	28	60.50	2-3/8"	89	16	4	12
3/4"	34	69.85	2-3/4"	98	16	4	12
1"	42	79.25	3-1/8"	108	16	4	16
1-1/4"	51	88.90	3-1/2"	117	16	4	16
1-1/2"	62	98.55	3-7/8"	127	16	4	18
2"	78	120.65	4-3/4"	152	19	4	18
2-1/2"	92	139.70	5-1/2"	178	19	4	18
3"	111	152.40	6"	191	19	4	20
4"	133	190.50	7-1/2"	229	19	8	20
5"	133	190.50	7-1/2"	254	22	8	20
6"	178	241.00	9-1/2"	279	22	8	24
8"	236	298.45	11-3/4"	343	22	8	28
10"	288	361.95	14-1/4"	406	25	12	30
12"	338	431.80	17"	483	25	12	32
▲ 14"	376	476.25	18-3/4"	533	29	12	28
▲ 16"	430	539.75	21-1/4"	597	29	16	28
▲ 18"	517	577.85	22-3/4"	635	32	16	30
▲ 20"	533	635.00	25"	699	32	20	30
▲ 24"	645	749.30	29-1/2"	813	35	20	30

▲ 钢制产品(Steel ones)